

DO's

It requires special fabrication guidelines

- Always supply in as flat Sheets
- Pre-condition the colorcore sheet and the substrate for 3 days in the temp/humidity conditions of the installation site
- Sheets should be neatly stored horizontally with the top sheet turned down.

- Use MDF / A grade Calibrated plywood as the substrate

- Use PVA adhesives (Fevicol SH or equivalent)
- Substrate should be free from dust & dirt before applying adhesive
- Adhesive must be applied evenly across the complete surfaces of both the substrate and laminate.
- Allow the adhesive to achieve the right tack level before sticking both the surfaces.

- Internal corners should be radiused
- out to as large as possible
- Use butt joint technique

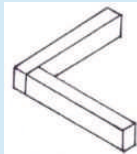
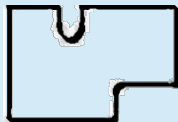

- Recommended handheld tools



Router

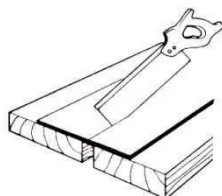

Hand plane

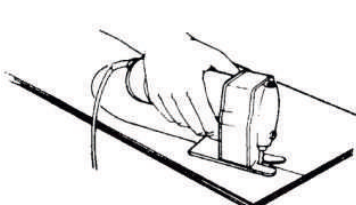

Jig Saw

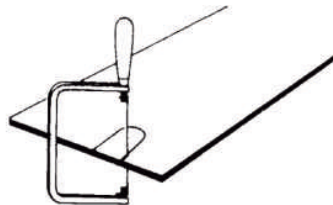

Coping Saw

DON T's

This is not a general purpose laminate

- Never supply as rolled sheets
- Never store the sheets vertically
- Don't remove the peel coat
- unless the site is ready for use.



- Don't use Gypsum , Plaster , concrete or Solid laminate

- Normal PVA contact adhesives are not recommended (Don't use Fevicol SR)
- Adhesive layer must not be too thick
- Never bond two surfaces when the adhesive is gone too dry

- No 90 degree cuts
- No Sharp internal corners

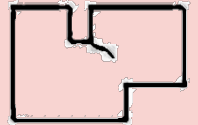

Never use

- Laminate cutter
- Carbide tip
- Chisel



DO's

- Recommended blades to be used in hand held Jig Saw



- Always drill a pilot hole before using screws
- Drilled holes should be bigger than screw by .25mm

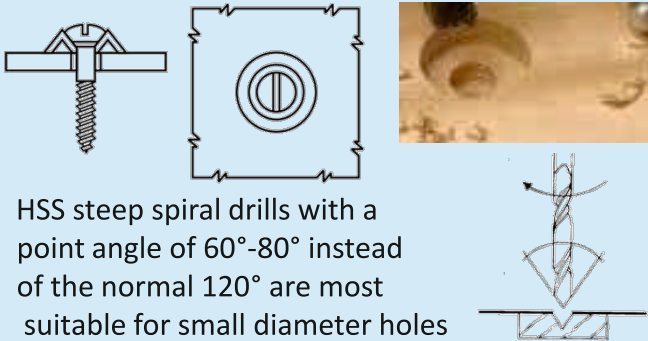

- HSS steep spiral drills with a point angle of 60°-80° instead of the normal 120° are most suitable for small diameter holes

- Smoothen the edge using abrasive paper or planing
- Edge chamfering 45 deg – with router

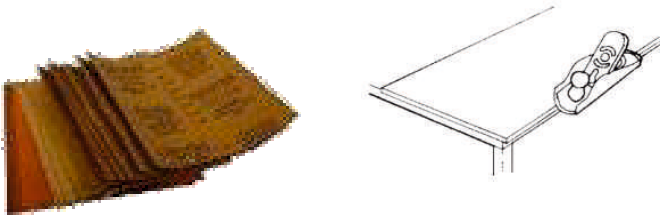

- Use small panel (Max. 600mm x 2100mm) for vertical fabrication/installation
- Maintain gap of 2mm between joints

- In case of overlap at edges , larger panel shall overlap the edges
- Example : While making table, only the top surface (large panel) overlaps the side pasted laminate, so if any expansion happen it will get the space to expand.

- Backing board / balancer is required to prevent warping and cracking

DON'T's

- Not recommended for hand held Jig Saw use



- Drilled holes should not be of same size as Screw
- Don't ever use the hammer
- Never use nail

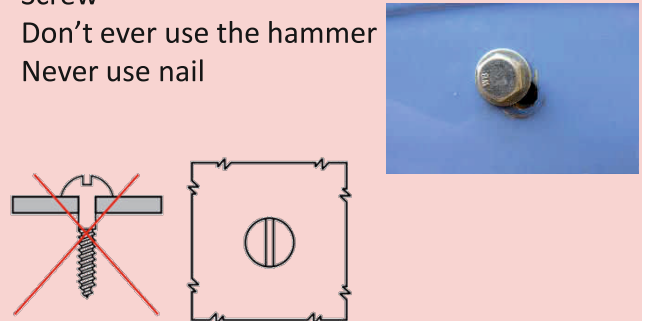

- Make sure there is no chipping on the edges

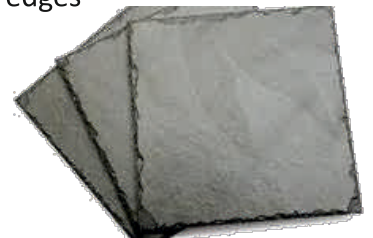

- Large panels are not recommended for vertical application unless fabricated at the workshop using cold press

- Never let the larger panel overlap the smaller one

- In case of no backing board / balancer there is a risk of warping